

ICA-320-SGT



ICA-624-ZEGG

(2,54mm) .100"

ICA SERIES

# AUTOMATED INSERTION DIP SOCKETS

Mates with:  
APA

ICA

ROW SPACING &  
NO. OF CONTACTS

STYLE  
OPTION

PLATING  
OPTION

OPTION  
(Leave Blank for  
Standard Version)

Specify from chart below

- Side & end stackable
- Great for auto insertion
- Open body design

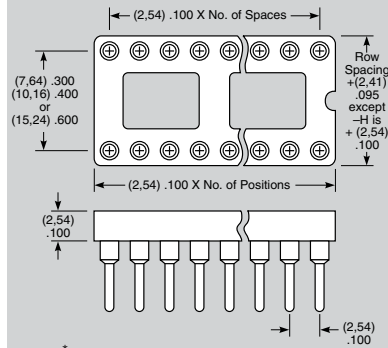

Style	Row Space	No. of Contacts
-308	.300 (7,62)	08
-314		14
-316		16
-318		18
-320		20
-322*		22
-324	.400 (10,16)	24
-328		28
-422	.600 (15,24)	22
-624		24
-628		28
-632		32
-640		40
-648		48

**GG**

= 30μ" (0,76μm)  
Gold contact,  
10μ" (0,25μm)  
Gold Shell

**GT**

= 30μ" (0,76μm)  
Gold contact,  
Tin Shell

**ST**

= 10μ" (0,25μm)  
Gold contact,  
Tin shell (Styles -S  
& -ZS only)

**-2**  
= .360 (9,14)  
Tail

**Wire-Wrap  
Option**

Requires Style  
-W or -ZW  
Specify desired  
suffix for shorter  
Wire-Wrap tail.

**-3**  
= .260 (6,60)  
Tail

**-L**  
= Locking  
Socket

Requires Style  
-S or -ZS

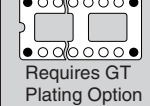

Requires GT  
Plating Option

## SPECIFICATIONS

For complete specifications  
see [www.samtec.com?ICA](http://www.samtec.com?ICA)

**Insulator Material:**  
Black Glass Filled  
Polyester  
except -328 is LCP  
**Contact:** BeCu  
**Shell:** Brass



**Plating:**

Au or Sn over 50μ" Ni  
**Flammability Rating:**  
UL 94V-O

**Insulation Resistance:**  
5000 MΩ min

**Temperature Range:**  
-55°C to +105°C with Tin  
-55°C to +125°C with Gold.

**Withstanding Voltage:**  
1000 VRMS

**Current Rating:** 1A  
**Contact Resistance:**  
10mΩ max

**Lead Size Range:**  
.015" (0,38mm) to .022"  
(0,56mm) DIA and most IC leads

**Insertion Force:**  
(Single contact only)  
Standard = 9 oz avg, 16 oz max;  
Low Insertion Force =  
2.5 oz avg, 5.5 oz max

**Withdrawal Force:**  
(Single contact only)  
Standard = 2.5 oz avg, 1.5 oz  
min; Low Insertion Force =  
2.0 oz avg, 0.35 oz min

**Lead-Free Solderable:**  
Wave only

**RoHS Compliant:** Yes

**Note:** Some sizes, styles and  
options are non-standard,  
non-returnable.

**-S, -ZS, -ZA**

= Printed Circuit  
-ZS & -ZA = Low Insertion Force

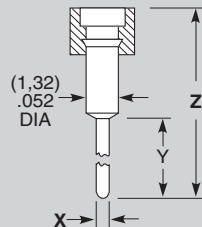

LEAD STYLE	X DIA	Y TAIL	Z
-S or -ZS	(0,51) .020	(3,18) .125	(7,62) .300
-ZA	(0,51) .020	(4,57) .180	(8,89) .350

Locking lead  
available with -S  
and -ZS.  
See OPTION.

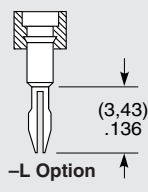

Insertion Depth = .095" (2,41) to .145" (3,68):  
Style S Component Part No. = SC-1P1  
Style ZS Component Part No. = EZ-1P1  
Style ZA Component Part No. = EZ-6P1  
Option L Component Part No. = SC-1L1 or EZ-1L1

**-W, -ZW**

= Wire-Wrap  
ZW = Low Insertion Force

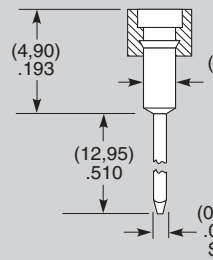

Shorter wire-wrap tail  
lengths available.  
See OPTION.

Insertion Depth = .125" (3,18) to .157" (3,99)  
Style W Component Part No. = SC-1W1(1)  
Style ZW Component Part No. = EZ-1W1(1)  
Style W-2 Component Part No. = SC-1W1(2)  
Style ZW-2 Component Part No. = EZ-1W1(2)  
Style W-3 Component Part No. = SC-1W1(3)  
Style ZW-3 Component Part No. = EZ-1W1(3)

**-ZE**

= Elevated  
Low Insertion Force

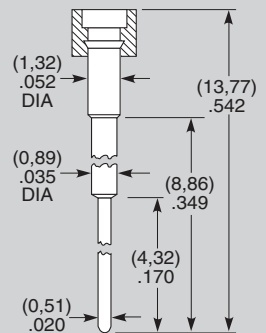

Insertion Depth = .125" (3,18) to .170" (4,32)  
Style ZE Component Part No. = EZ-2P3

Due to technical progress, all designs, specifications and components are subject to change without notice.

[WWW.SAMTEC.COM](http://WWW.SAMTEC.COM)